



**LEGEND:**

-  Student with social distancing indicated
-  Staff member with social distancing indicated

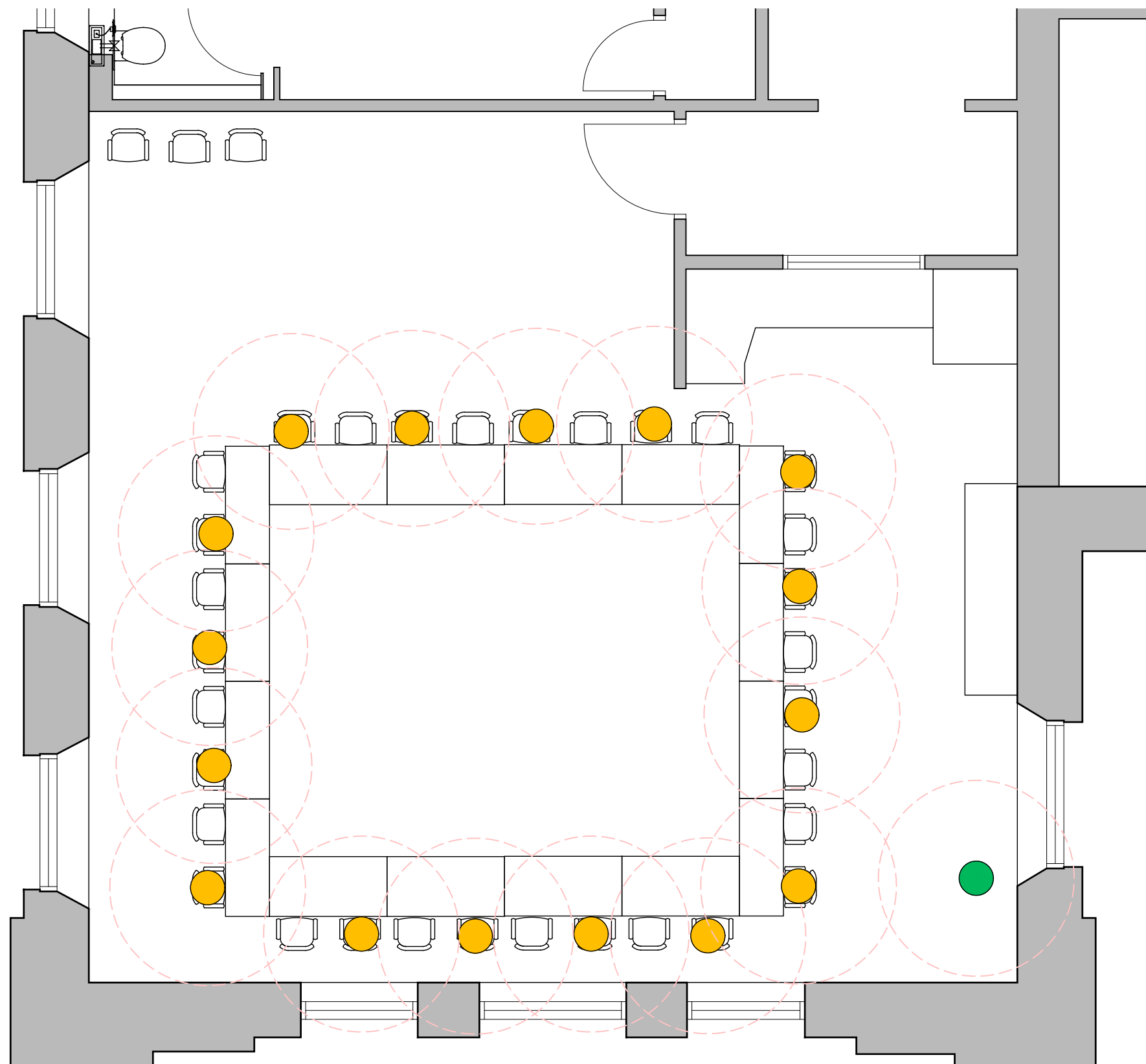

**Room 3.08**

Full (current) Occupancy = 35

45% Occupancy with 1m Social Distancing = 16

**WellwoodLeslie**  
ARCHITECTS

Fort Street House, 63 Fort Street,  
Broughty Ferry, Dundee, DD5 2AB  
t: 01382 778829 e: admin@wellwoodleslie.com

Client  
University of Dundee  
Project  
Social Distancing Study  
Project Address  
Scrymgeour Building

Drawing Title  
Room 3.08

| Job No. | Dwg No.  | Revision No. |
|---------|----------|--------------|
| 4045    | 9433-302 | B            |

© The contents of this drawing remain the intellectual property of WellwoodLeslie Architects.

01

9433-302

Room 3.08 - Level 3 - Social Distancing

1:50 @ A3